



ADDENDUM #2

2010 Residential Street Resurfacing Program

2010-6285-2011

May 17, 2010

City of Newport News

OFFICE OF THE PURCHASING DIRECTOR

2400 Washington Avenue

Newport News, VA 23607

Phone: (757) 926-8031/ Fax: (757) 926-8038

nngov.com/purchasing

Sealed bids, subject to the conditions and instructions contained herein, will be received at the above office of the Purchasing Director, 4th Floor, City Hall, 2400 Washington Avenue, Newport News, Virginia, 23607, until the time and date shown below (local prevailing time), for furnishing the items or services described in the invitation for bid.

It is agreed and understood the following six (6) revised pages (B-3, B-4, B-5, B-10, C-3, and C-4) and two (2) drawings Old Oyster Point Road Improvements Project constitute addendum #2, and shall be made part of the original IFB document, as per the table of contents.

The bid due date remains to be: **May 25, 2010 @ 2:00 p.m.**

Contract Officer: _____
Shari D. Colvin, CPPB, VCO, Deputy Director, scolvin@nngov.com

Please sign and return with your response.

Company Name: _____

Address: _____

City/State/Zip: _____

Telephone: _____ FAX No.: _____

E-mail: _____

Print Name: _____ Title: _____

Signature: _____ Date: _____

This Form Must Be Signed. Signature must be original, not photocopied)

Street Name	From	To	Street Area (SY)	SM-9.5 (Ton) 2"	BM-25 (Ton) 3"
Monarch Dr.	Menchville Rd.	Woodburn La.	4401.8	528.2	792.3
Roanoke Ave.	78 th St.	81 st St (Hampton)	3333.3	400.0	799.9 (4")
Yves Cir.	Lafayette Terr.	Cul-de-Sac	1269.1	152.3	228.4
Rochester Ct. N	48 th St.	Dead End	1784.7	214.2	321.2
Rochester Ct. S	48 th St.	Dead End	1784.7	214.2	321.2
Meeting Rd.	James Landing Rd.	James Landing Rd.	4490.7	538.9	808.3
Maple Ave.	Chesapeake Ave.	25 th St.	10686.7	1282.4	1923.6
19 th St.	Walnut Ave.	Pear Ave.	9302.2	1116.3	1674.4
32 nd St.	Orcutt Ave.	Roanoke Ave.	2100.0	252.0	378.0
33 rd St.	Orcutt Ave.	Roanoke Ave.	2100.0	252.0	378.0
Wilmington La.	Shannon Dr.	Cul-de-Sac	2691.3	323.0	484.4
Shannon Dr.	Moyer Rd.	Cascade Dr.	3555.6	426.7	640.0
Cornell Dr.	Cascade Dr.	Elder Rd.	3946.7	473.6	710.4
Lacon Dr.	Beechmont Dr.	Cornell Dr.	4266.7	512.0	768.0
D La.	Lacon Dr.	Cul-de-Sac	2478.0	297.4	446.0
Alan Dr.	Tillerson Dr.	Crutchfield Dr.	3788.9	417.7	625.0
Chipley Dr.	Motaka Dr.	Alan Dr.	2659.0	292.0	439.0
11 th St.	Wickham Ave.	Marshall Pl.	1290.0	154.8	232.2
14 th St.	Wickham Ave.	Marshall Pl.	2070.0	248.4	372.6
Marshall Pl.	11 th St.	14 th St.	2445.0	293.4	440.1
Dogwood Dr.	Country Club Rd.	Dead End	4408.9 C&G	529.1	793.6
Mistletoe Dr.	Country Club Rd.	Dead End	4408.9 C&G	529.1	793.6
30 th St.	Orcutt Ave.	Roanoke Ave.	2100.0 C&G	252.0	378.0
31 st St.	Orcutt Ave.	Roanoke Ave.	2100.0 C&G	252.0	378.0
Operations Dr.	Jefferson Ave.	Front Roadyard Gate	7111.1	853.3	0
Operations – Rear Parking Lot			1154.3	138.5	0
Operations – Front of Building			5857.4	702.9	0
Lions Bridge	South End	North End	2933.3	352.0	0
Museum Pkwy.	Museum Dr.	Riverside Dr.	4000.0	480.0	0
Roanoke Ave.	Briarfield Rd.	41 st St.	17692.9	2123.1	0
Oyster Point Rd.	Jefferson Ave.	Thru Canon Blvd.	40,000.0	4,800.0	0
Old Oyster Point Road	Atkins Lane	J.C.M. Blvd	350 SY Milling	25	20

Revised B-3

ITEM	QTY	UNIT	DESCRIPTION	UNIT PRICE	TOTAL PRICE
1	15,000	TN	SM-9.5A Bituminous Concrete		
2	140,000	SY/IN	Variable Depth and Width Milling of Asphalt/Stone		
3	1,000	TN	SM-9.5A Bituminous Concrete Parking Lot Area		
4	500	TN	SM-1 Leveling/Scratching		
5	16,000	TN	BM-25 Bituminous Concrete		
6	50	CY	Crushed Stone Backfill		
7	500	CY	Asphalt/Stone/Subgrade Removal		
8	1,500	TN	BM-25 Backfill		
9	200	TN	Crushed Stone Shoulder		
10	30	EA	Adjust Manholes to Proper Grade/Lower or Raise Casting		
11	10	EA	Newport News Standard Manhole Casting		
12	50	EA	Adjust Water Valves to Proper Grade/Lower or Raise Casting		
13	50	EA	Adjust Manholes/Install Rings		
14	2	EA	Adjust Water Valves/Install Rings		
15	25,000	FT	4" Pavement Line Markings		
16	100	FT	6" Pavement Line Markings		
17	500	LF	Curb and Gutter Replacement		
18	700	FT	24" Pavement Line Markings		
19	300	FT	4" Pavement Line Markings (Parking Lot Area)		
20	30	EA	Single Arrow – Pavement Marking		
21	5	EA	Double Arrow – Pavement Marking		
22	100	EA	Raised Pavement Marker – Double Sided w/ Steel Casting		
23	18,000	FT	#14 THNN Stranded Loop Detector Wire		
24	6,300	FT	Saw Cut in Concrete or Asphalt (Signal Loops)		
25	LS	LS	Traffic Control For Residential St. Resurfacing		
26	LS	LS	Temporary Pavement Markings		
27	LS	LS	Preparation of Traffic Control Plans		
28	10	EA	Replace Asphalt Wedge in Driveway		
29	500	SY	4" Sidewalk Replacement		
30	10,000	LF	Curb and Gutter Replacement/6" Stone Base (Machine Required for Installation)		
31	3,700	CY	Regular Excavation (Chipley Drive/Alan Drive)		
32	7,700	SY	8" VDOT #21A Stone (Chipley Drive/Alan Drive)		
33	7,700	SY	4" Additional VDOT #21A Stone (Chipley Drive/Alan Drive)		
34	400	CY	Additional Excavation and CBR20 Material Backfill (Chipley Drive/Alan Drive)		
35	7,700	SY	AMCO 2016 Woven Geotextile Fabric (Chipley Drive/Alan Drive)		

36	4,100	LF	Curb and Gutter Replacement/6" Stone Base (Chipley Drive/Alan Drive). Curb and Gutter Machine Required for Installation		
37	650	SY	7" Concrete Driveway Replacement (Chipley Drive/Alan Drive)		
38	2	LS	Mobilization/Traffic Control for Chipley Drive/Alan Drive Reconstruction		
39	7	EA	Replace and Lower/Raise Existing Curb Drop Inlet Top (Chipley Drive/Alan Drive)		
40	1	LS	Mobilization/Traffic Control for Oyster Point Road from Jefferson thru Canon Blvd.		
41	1	LS	Mobilization/Traffic Control for Old Oyster Point Road & Harpersville Road		
42	420	SY	New 4" Concrete Sidewalk		
43	200	SY	Replacement of 7" Concrete Driveway		
44	18	EA	7" Concrete ADA Handicap Ramp		
45	280	LF	Fill Existing Ditch, Cut New Ditch & Grade		
46	250	CY	Compacted Embankment Fill & Grade a New Swale to Drain		
47	500	LF	14"x23" HERCP Class IV w/4" Stone Bedding		
48	60	LF	8" Ductile Iron Pipe		
49	60	LF	15" RCP Class III w/4" Stone Bedding		
50	6	EA	Cast-In-Place N.N. Standard Yard Drain		
51	1	EA	Convert Existing Yard Drain to Manhole		
52	300	LF	Relocate/Replace Existing Concrete Median to 4' Standard VDOT MS-1 w/Dowels @ 2' CC		
53	1	LS	4" Top Soil, Fine Grade, Fertilizer & Seed		
54	1	LS	Erosion & Sedimentation Control		
55	4,800	TN	SM-12.5D Bituminous Concrete		

Total Bid: _____

Revised B-5

Regular Excavation: Payment for regular excavation shall be at the cubic yard price as bid. Regular excavation shall consist of the removal and proper disposal of material, regular cut, regular fill. Regular excavation is defined as including all incidental work required to shape, grade, and construct the roadway and adjacent areas in accordance with City Standard cross-sections and City stake-out or as directed in the field by the Engineer or the Inspector. This item also includes cutting, filling, and shaping existing ditches/swales and grading all areas (including areas beyond the right-of-way line) in order to provide positive drainage as required in the field by the Engineer or the Inspector. All construction traffic shall not be permitted on subgrade, stone/sand shall be end dumped, pushed into place and compacted. As directed by the Inspector, subgrade damaged by poor construction operations shall be undercut and

backfilled at the Contractor's expense. All existing manhole castings, water valve castings, HRSD castings, and all other castings/enclosures shall be adjusted to proper grade to match final roadway grades just prior to surface mix placement. Excavation shall also include all compaction required to construct roadways and shoulders and removal and disposal of existing concrete/asphalt/stone pavement, subgrade, and all miscellaneous concrete (including saw cutting required by the Inspector), rubble, debris, and tree roots. Payment shall also include preparation of the subgrade for pavement section and disposal off-site of all excess or unsuitable material.

8" VDOT #21A Stone and 4" Additional VDOT #21A Stone: Payment shall be at the square yard price bid for 8" or 4" 21A or 21B stone furnished, installed, graded, compacted and based on field measurements conducted by the Inspector. Field conditions shall determine the use of a portion or all of the 4" additional stone base.

Additional Excavation and CBR-20 Material Backfill: Payment shall be made by the cubic yard price as directed by the Inspector, field measured in place. The price shall include excavation, furnishing, placing, and compaction of material. Field conditions shall determine the area of placement.

AMCO 2016 Woven Geotextile Fabric: Payment shall be made by the square yard price bid installed. The price shall include all materials and labor for placement of the fabric in accordance with the manufacturer specifications or as directed in the field by the Inspector. Field conditions shall determine the use of a portion or all of the fabric.

7" Concrete Driveway Replacement: Payment shall be made by the square yard price as bid for the 7" thick concrete driveway replacement field measured in place. New driveways shall be placed to provide a smooth transition to existing driveways (straight edge saw cutting required at existing concrete driveway connection which shall be included in the unit price bid). The price shall include all materials, labor, equipment, saw cutting, excavation, concrete removal, and disposal of excess material and concrete placement, fine grading, compaction of subgrade materials, 4" topsoil and seeding of disturbed areas. Any manholes, valves and meter enclosures that need to be adjusted shall be included in the unit price.

Replace and Lower/Raise Existing Curb Drop Inlet Top: Payment shall be made at the unit price bid to remove existing top, lower and place new curb drop inlet top at proposed grades as shown on plans. Price includes modifications to existing structure and all related items to lower the existing curb drop inlet to grade.

Unit Prices for work on Old Oyster Point/Harpersville Road shall include all necessary labor, materials and equipment to demolish/excavate, fill, shape, grade and install driveways, sidewalks, concrete medians, storm sewers, pavement in accordance to the plans and City stake-out. This item also includes cutting, filling, and shaping existing/new ditches/swales and grading all areas (including areas beyond the right-of-way line) in order to provide positive drainage as required in the field by the Engineer or the Inspector.

ITEM	QTY	UNIT	DESCRIPTION	UNIT PRICE	TOTAL PRICE
1	15,000	TN	SM-9.5A Bituminous Concrete		
2	140,000	SY/IN	Variable Depth and Width Milling of Asphalt/Stone		
3	1,000	TN	SM-9.5A Bituminous Concrete Parking Lot Area		
4	500	TN	SM-1 Leveling/Scratching		
5	16,000	TN	BM-25 Bituminous Concrete		
6	50	CY	Crushed Stone Backfill		
7	500	CY	Asphalt/Stone/Subgrade Removal		
8	1,500	TN	BM-25 Backfill		
9	200	TN	Crushed Stone Shoulder		
10	30	EA	Adjust Manholes to Proper Grade/Lower or Raise Casting		
11	10	EA	Newport News Standard Manhole Casting		
12	50	EA	Adjust Water Valves to Proper Grade/Lower or Raise Casting		
13	50	EA	Adjust Manholes/Install Rings		
14	2	EA	Adjust Water Valves/Install Rings		
15	25,000	FT	4" Pavement Line Markings		
16	100	FT	6" Pavement Line Markings		
17	500	LF	Curb and Gutter Replacement		
18	700	FT	24" Pavement Line Markings		
19	300	FT	4" Pavement Line Markings (Parking Lot Area)		
20	30	EA	Single Arrow – Pavement Marking		
21	5	EA	Double Arrow – Pavement Marking		
22	100	EA	Raised Pavement Marker – Double Sided w/ Steel Casting		
23	18,000	FT	#14 THNN Stranded Loop Detector Wire		
24	6,300	FT	Saw Cut in Concrete or Asphalt (Signal Loops)		
25	LS	LS	Traffic Control For Residential St. Resurfacing		
26	LS	LS	Temporary Pavement Markings		
27	LS	LS	Preparation of Traffic Control Plans		
28	10	EA	Replace Asphalt Wedge in Driveway		
29	500	SY	4" Sidewalk Replacement		
30	10,000	LF	Curb and Gutter Replacement/6" Stone Base (Machine Required for Installation)		
31	3,700	CY	Regular Excavation (Chipley Drive/Alan Drive)		
32	7,700	SY	8" VDOT #21A Stone (Chipley Drive/Alan Drive)		
33	7,700	SY	4" Additional VDOT #21A Stone (Chipley Drive/Alan Drive)		
34	400	CY	Additional Excavation and CBR20 Material Backfill (Chipley Drive/Alan Drive)		
35	7,700	SY	AMCO 2016 Woven Geotextile Fabric (Chipley Drive/Alan Drive)		

36	4,100	LF	Curb and Gutter Replacement/6" Stone Base (Chipley Drive/Alan Drive). Curb and Gutter Machine Required for Installation		
37	650	SY	7" Concrete Driveway Replacement (Chipley Drive/Alan Drive)		
38	2	LS	Mobilization/Traffic Control for Chipley Drive/Alan Drive Reconstruction		
39	7	EA	Replace and Lower/Raise Existing Curb Drop Inlet Top (Chipley Drive/Alan Drive)		
40	1	LS	Mobilization/Traffic Control for Oyster Point Road from Jefferson thru Canon Blvd.		
41	1	LS	Mobilization/Traffic Control for Old Oyster Point Road & Harpersville Road		
42	420	SY	New 4" Concrete Sidewalk		
43	200	SY	Replacement of 7" Concrete Driveway		
44	18	EA	7" Concrete ADA Handicap Ramp		
45	280	LF	Fill Existing Ditch, Cut New Ditch & Grade		
46	250	CY	Compacted Embankment Fill & Grade a New Swale to Drain		
47	500	LF	14"x23" HERCP Class IV w/4" Stone Bedding		
48	60	LF	8" Ductile Iron Pipe		
49	60	LF	15" RCP Class III w/4" Stone Bedding		
50	6	EA	Cast-In-Place N.N. Standard Yard Drain		
51	1	EA	Convert Existing Yard Drain to Manhole		
52	300	LF	Relocate/Replace Existing Concrete Median to 4' Standard VDOT MS-1 w/Dowels @ 2' CC		
53	1	LS	4" Top Soil, Fine Grade, Fertilizer & Seed		
54	1	LS	Erosion & Sedimentation Control		
55	4,800	TN	SM-12.5D Bituminous Concrete		

Total Bid: _____

Revised C-4



DESIGNED T. CHENEY
 DRAWN BY C. STOUGH
 CHECKED K. DUGAN
 APPROVED *T. C. Gentry*
 DIRECTOR OF ENGINEERING
 Date 5/11/10

REVISIONS	DATE

CITY OF NEWPORT NEWS
 DEPARTMENT OF ENGINEERING
 2400 WASHINGTON AVE.
 8th FLOOR
 NEWPORT NEWS, VA.
 PHONE: 926-8611

JOB TITLE
**OLD OYSTER POINT ROAD
 IMPROVEMENTS PROJECT**
 CITY OF NEWPORT NEWS

FILE NO. _____
 DATE MAY 2010
 SCALE 1" = 25'

SHEET
1
 of **2**

E7-375

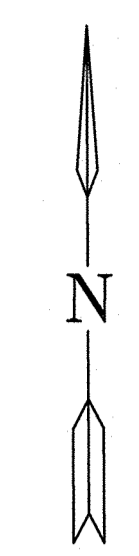
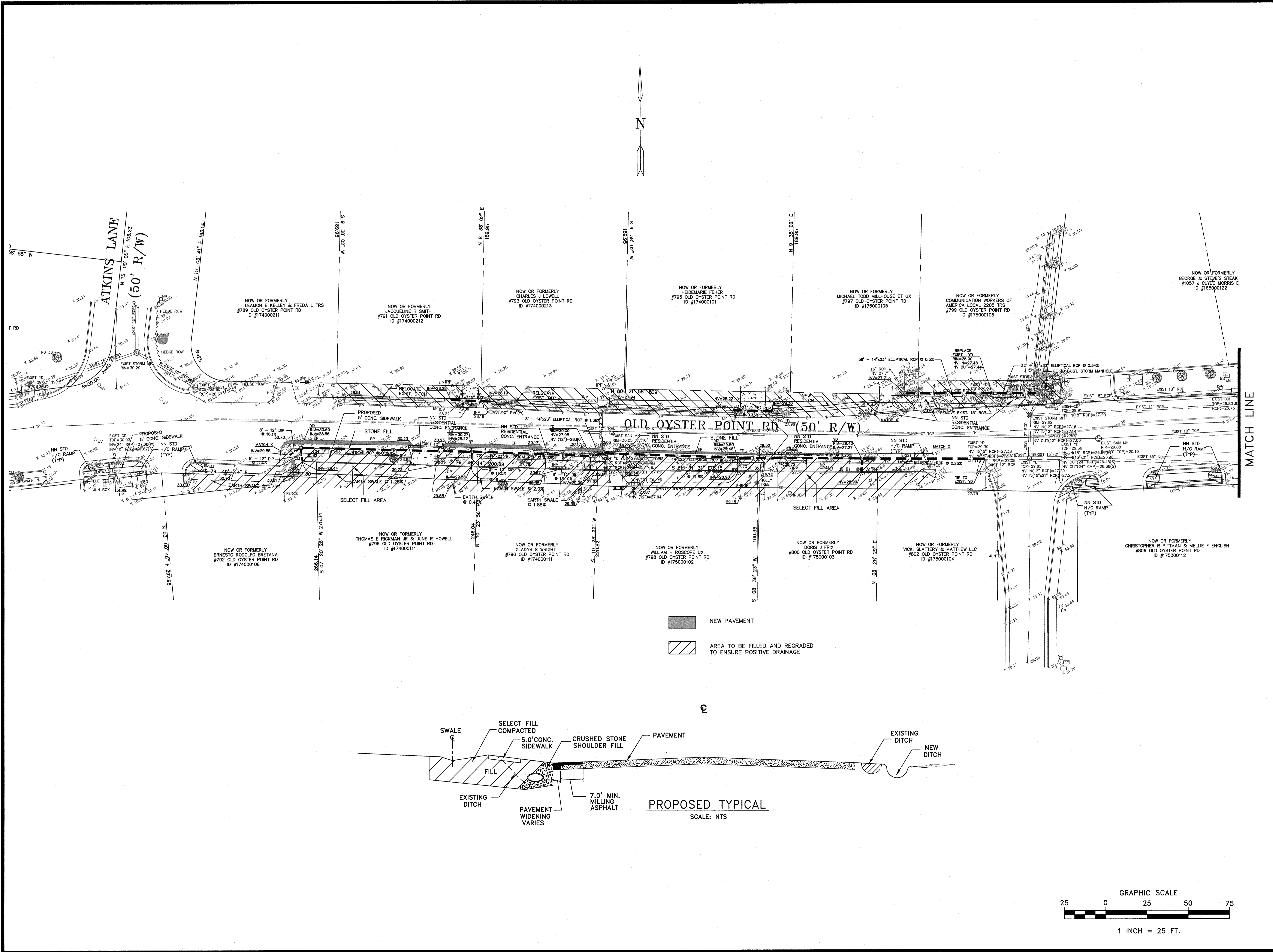

NEW PAVEMENT
 AREA TO BE FILLED AND REGRADED TO ENSURE POSITIVE DRAINAGE

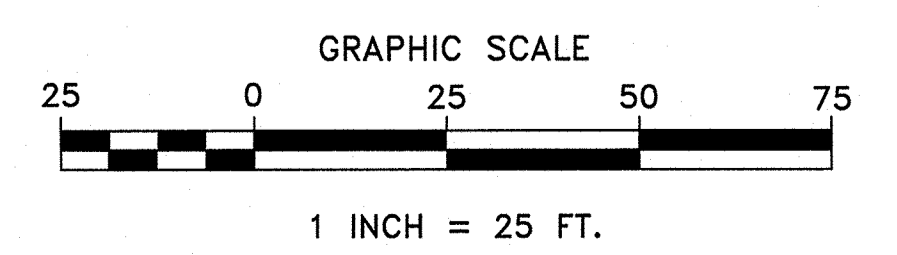
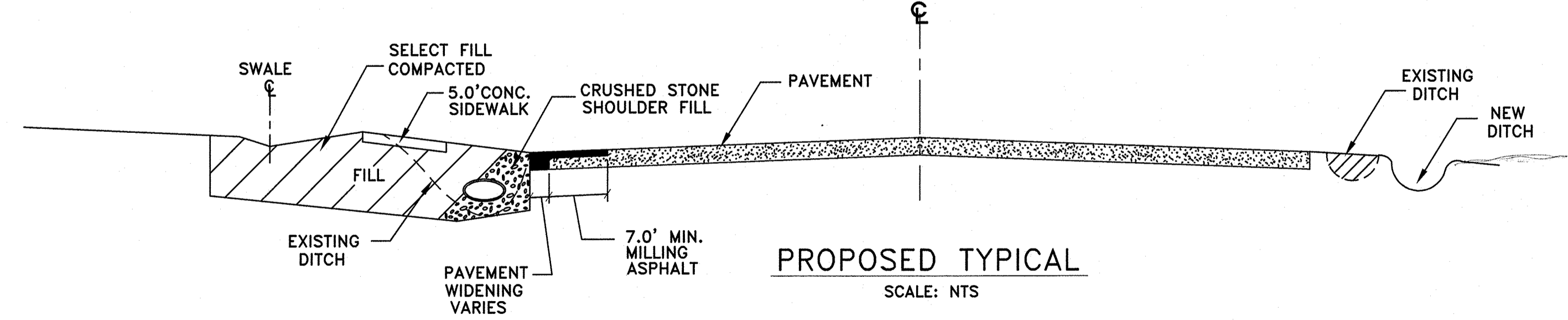

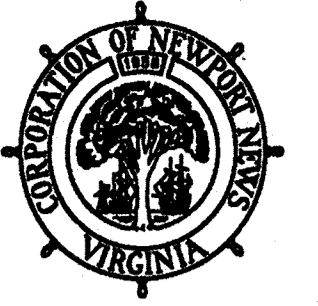

DESIGNED T. CHENEY
 DRAWN BY C. STOUGH
 CHECKED K. DUGAN
 APPROVED *John C. Young*
 DIRECTOR OF ENGINEERING
 Date 5/11/10

REVISIONS	DATE

CITY OF NEWPORT NEWS
 DEPARTMENT OF ENGINEERING
 NEWPORT NEWS, VA.
 PHONE: 926-8611
 2400 WASHINGTON AVE.
 8th FLOOR

JOB TITLE
**OLD OYSTER POINT ROAD
 IMPROVEMENTS PROJECT**
 CITY OF NEWPORT NEWS

FILE NO. _____
 DATE MAY 2010
 SCALE 1" = 25'

SHEET
2
 of
2

E7-375

