

FIRST LEVEL FLOOR PARTIAL PLAN
PART C - DEMOLITION AND NEW WORK

1 M-3 SCALE: 3/32" = 1'-0"

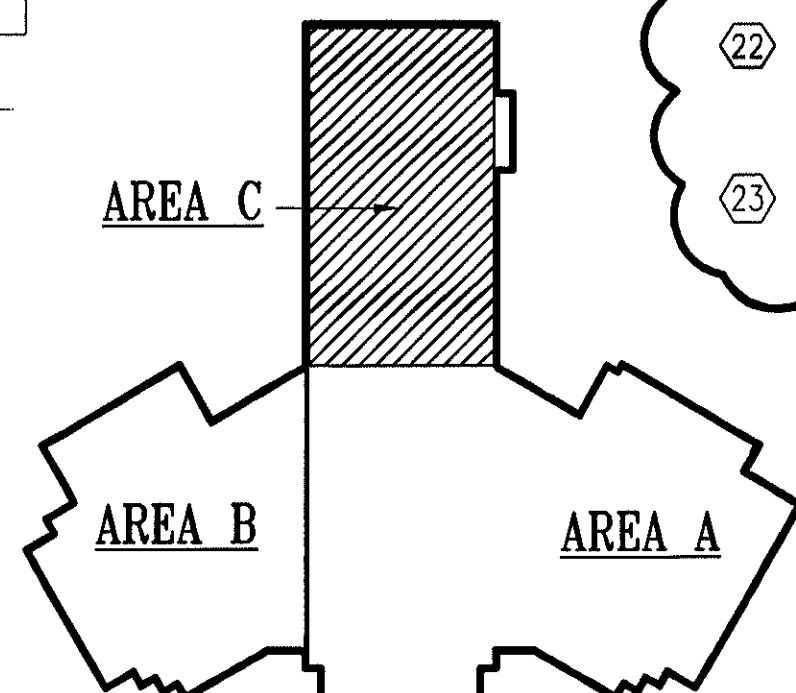

KEY PLAN

DEMOLITION SPECIFIC NOTES

- 1 MANUAL ON/OFF SWITCH FOR EF-7. REMOVE ELECTRICAL DISCONNECT, SWITCH, AND WIRING FROM EF-7.
- 2 MANUAL ON/OFF SWITCH FOR EF-1. REMOVE ELECTRICAL DISCONNECT, SWITCH, AND WIRING FROM EF-1.
- 3 MANUAL ON/OFF SWITCH FOR EF-5. REMOVE ELECTRICAL DISCONNECT, SWITCH, AND WIRING FROM EF-5.

DRAWING NOTES

- 1 ALL MOD'S SHALL BE FED FROM EXISTING PANEL L10.
- 2 THERMOSTATS SHALL BE LINE VOLTAGE ON/OFF SOLID STATE TYPE WITH 55' TO 100' SETPOINT RANGE AND 1' MAXIMUM DIFFERENTIAL.
- 3 LOUVER TO BE FACTORY FINISHED; FLUOROPOLYMER 3-COAT SYSTEM; COLOR TO MATCH OTHER EXISTING LOUVERS. PROVIDE AND INSTALL BIRDSCREEN.

NEW WORK SPECIFIC NOTES

- 1 PROVIDE THERMOSTAT AND INTERLOCK WITH EXISTING EF-7 (LOCATED ON PLATFORM 1) AND MOD'S.
- 2 PROVIDE 48"x24" LOUVER WITH 48"x24"x24" DEEP SHEET METAL PLENUM AND MOD.
- 3 NOTE NOT USED.
- 4 LOCATE BOTTOM OF LOUVER AT 8 FEET ABOVE FINISHED FLOOR. LOUVER SHALL FALL IN CMU COURSING. COORDINATE LOUVER LOCATION WITH CONDUIT IN WALL. RELOCATE CONDUIT AS REQUIRED.
- 5 CONNECT EXHAUST DUCT FROM EF-22 TO EXISTING 88"x108" SHEET METAL PLENUM. DUCT SHALL BE CONNECTED BELOW EXISTING 18"Ø DUCT.
- 6 PROVIDE 48"x48" LOUVER AND LOCATE BOTTOM OF LOUVER AT 8 FEET AFF. LOUVER SHALL FALL IN CMU COURSING.
- 7 DUCT SHALL RISE AFTER CROSSING UNDER EXISTING BEAM. DUCT SHALL RUN DIAGONAL WITH ROOF TO PLATFORM # 1. REFER TO ME-4 FOR SUPPLY GRILLE HEIGHT.
- 8 PROVIDE 48"x48" LOUVER AND LOCATE BOTTOM OF LOUVER 8" ABOVE DOOR. LOUVER SHALL FALL IN CMU COURSING.
- 9 RUN DUCT ABOVE ACOUSTICAL TILE IN CORRIDOR ADJACENT TO PLATFORM # 2.
- 10 DUCT TO RISE TO PLATFORM # 2. REFER TO ME-4 FOR DUCT LOCATIONS & COORDINATION.
- 11 PROVIDE THERMOSTAT AND INTERLOCK WITH EXISTING EF-1 AND MOD'S.
- 12 PROVIDE THERMOSTAT & INTERLOCK WITH EXISTING EF-5 & MOD.
- 13 PROVIDE 2#12 & 1#12 G - 3/4" C FOR DAMPER MOTOR AND CONNECT TO EXISTING PANEL L10.
- 14 PROVIDE 2-1P, 15A CIRCUIT BREAKER IN EXISTING PANEL AND CONNECT TO TWO DAMPER CIRCUITS. CONNECT 5 DAMPER MOTORS IN ONE CIRCUIT.
- 15 PROVIDE 30"x60" LOUVER AND LOCATE BOTTOM OF LOUVER AT 8 FEET AFF. LOUVER SHALL FALL IN CMU COURSING. COORDINATE LOUVER LOCATION WITH EXISTING WATER LINES AND CONDUIT IN WALL. RELOCATE CONDUIT AS REQUIRED.
- 16 PROVIDE 60"x30" LOUVER AND LOCATE BOTTOM OF LOUVER AT 10 FEET AFF (ABOVE INTERIOR EXIT SIGN). LOUVER SHALL FALL IN CMU COURSING. COORDINATE LOUVER WITH EXTERIOR LIGHT AND CONDUIT IN WALL. RELOCATE CONDUIT AS REQUIRED.
- 17 PROVIDE 30"x60" LOUVER AND LOCATE BOTTOM OF LOUVER AT 10 FEET AFF (ABOVE INTERIOR EXIT SIGN). LOUVER SHALL FALL IN CMU COURSING. COORDINATE LOUVER WITH EXTERIOR LIGHT AND CONDUIT IN WALL. RELOCATE CONDUIT AS REQUIRED. LOUVER SHALL AVOID EXISTING STRUCTURAL STEEL.
- 18 TRANSITION DUCT TO RUN BETWEEN CONDUITS IN MECHANICAL ROOM.
- 19 DUCT TO TRANSITION TO AVOID DUCT IN PLATFORM # 1. REFER TO ME-4 FOR EXISTING DUCT LOCATION.
- 20 COORDINATE DUCT LOCATION WITH EXISTING SPRINKLER BRANCH. DUCT LOCATION SHALL NOT INTERFERE WITH SPRINKLER COVERAGE.
- 21 PROVIDE 36"x12" LOUVER AND LOCATE BOTTOM OF LOUVER AT 10 FEET AFF (ABOVE INTERIOR EXIT SIGN). LOUVER SHALL FALL IN CMU COURSING. COORDINATE LOUVER WITH EXTERIOR LIGHT AND CONDUIT IN WALL. RELOCATE CONDUIT AS REQUIRED.
- 22 PROVIDE 24"x48" LOUVER AND LOCATE BOTTOM OF LOUVER AT 8 FEET AFF. LOUVER SHALL FALL IN CMU COURSING. COORDINATE LOUVER WITH EXTERIOR LIGHT, FAN SWITCH, THERMOSTAT AND CONDUIT IN WALL. RELOCATE CONDUIT AS REQUIRED.
- 23 COORDINATE DUCT WITH EXISTING GAS AND FIRE SPRINKLER PIPING.

REVISIONS	
Addendum No. 2	5/14/2009

NEWPORT NEWS WATERWORKS

**CITY OF NEWPORT NEWS
DEPARTMENT OF PUBLIC UTILITIES
NEWPORT NEWS, VIRGINIA**

**LEE HALL
MAINTENANCE AND OPERATIONS CENTER**

GRAPHIC SCALES

SCALE: 3/32" = 1'-0"

SIGNATURE

5/14/09

WHITMAN, REQUARDT & ASSOCIATES, LLP
11870 MERCHANTS WALK, SUITE 100, NEWPORT NEWS, VA 23606

**FIRST LEVEL FLOOR
PARTIAL PLAN PART C
DEMOLITION AND NEW WORK**

Drawing No.
ME-3

Scale: 1/4" = 1'-0"

Date: APRIL 2009 Sheet 4 of 7

Des: SPR Drawn: PBF Check: CEH